

3000 LB SLAVE POT HAULER - REF. SP3F

INCORPORATING REPLACEABLE WEAR PLATES



SPENCER CARTER LTD
TREGONIGGIE INDUSTRIAL ESTATE
FALMOUTH
CORNWALL
TR11 4SN
U.K.

TEL. 01326 373423
FAX. 01326 373571
www.spencercarter.com
info@spencercarter.com

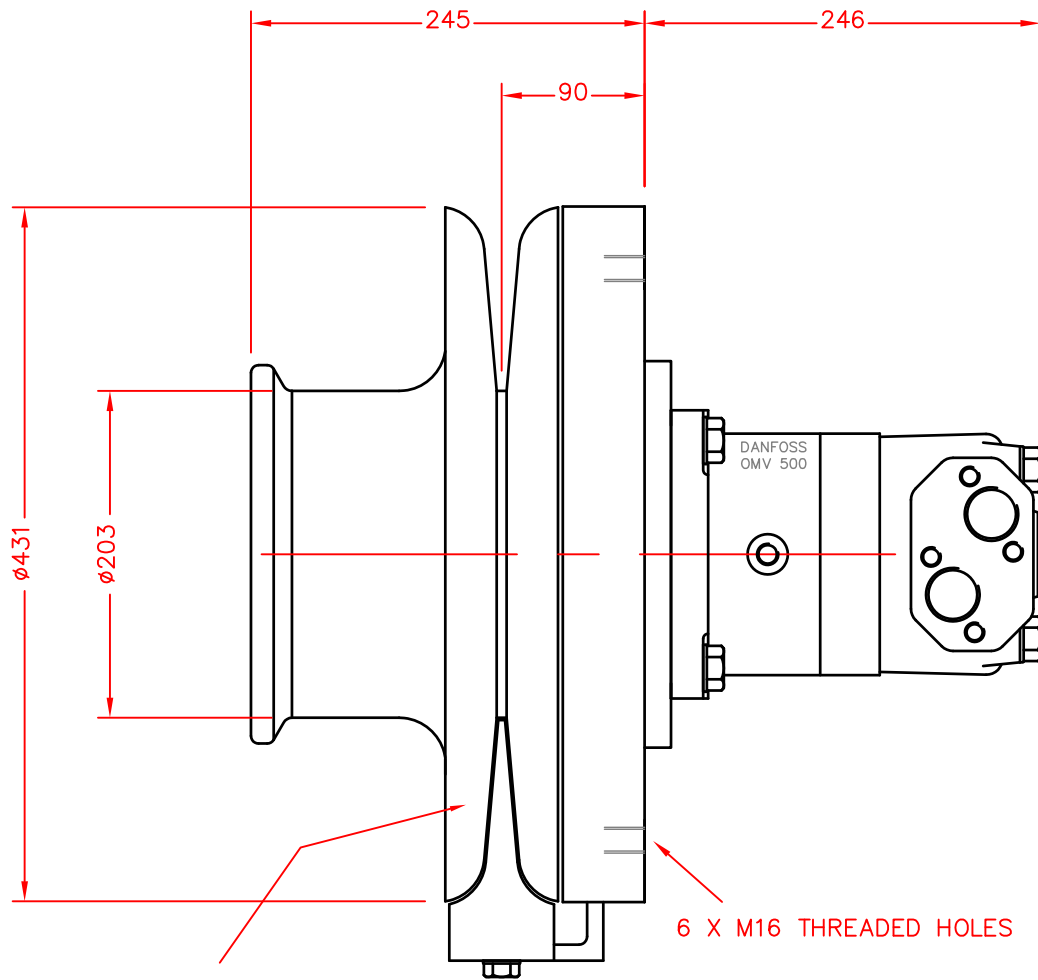

REPLACEABLE WEAR PLATES

6 X M16 THREADED HOLES

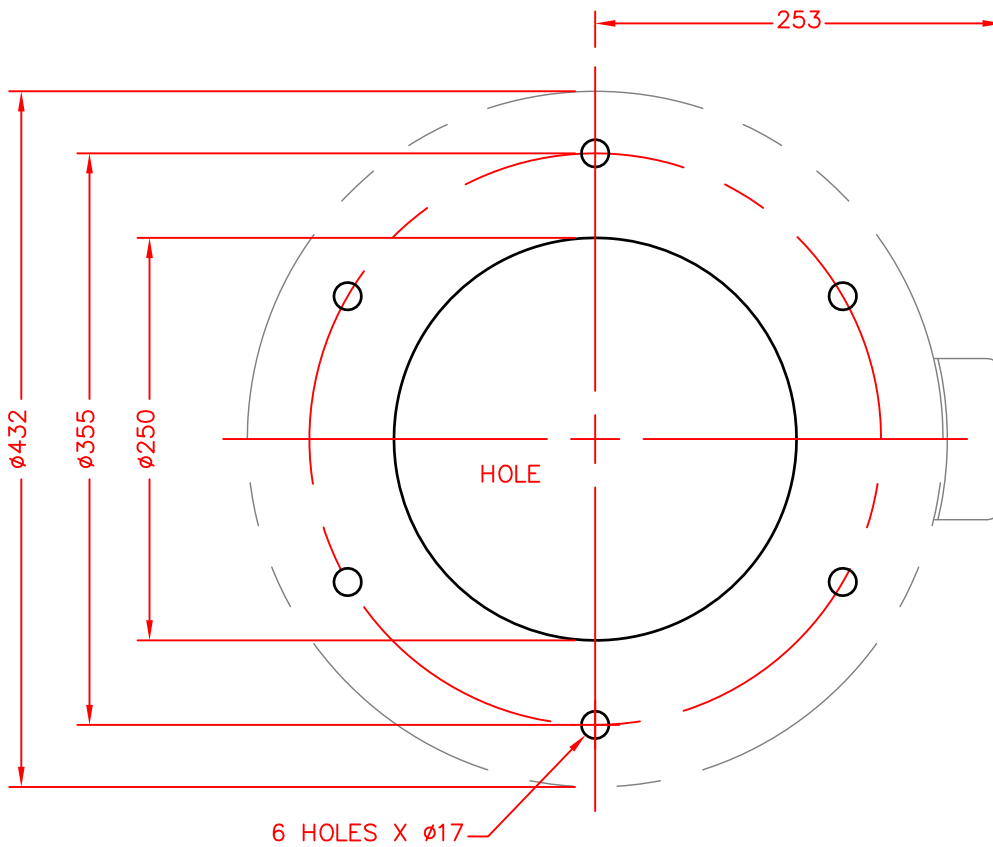

6 HOLES X $\phi 17$

POSITION OF LINE EJECTOR KNIFE IN RELATION TO BOLT HOLES.

BASE MOUNTING PLAN

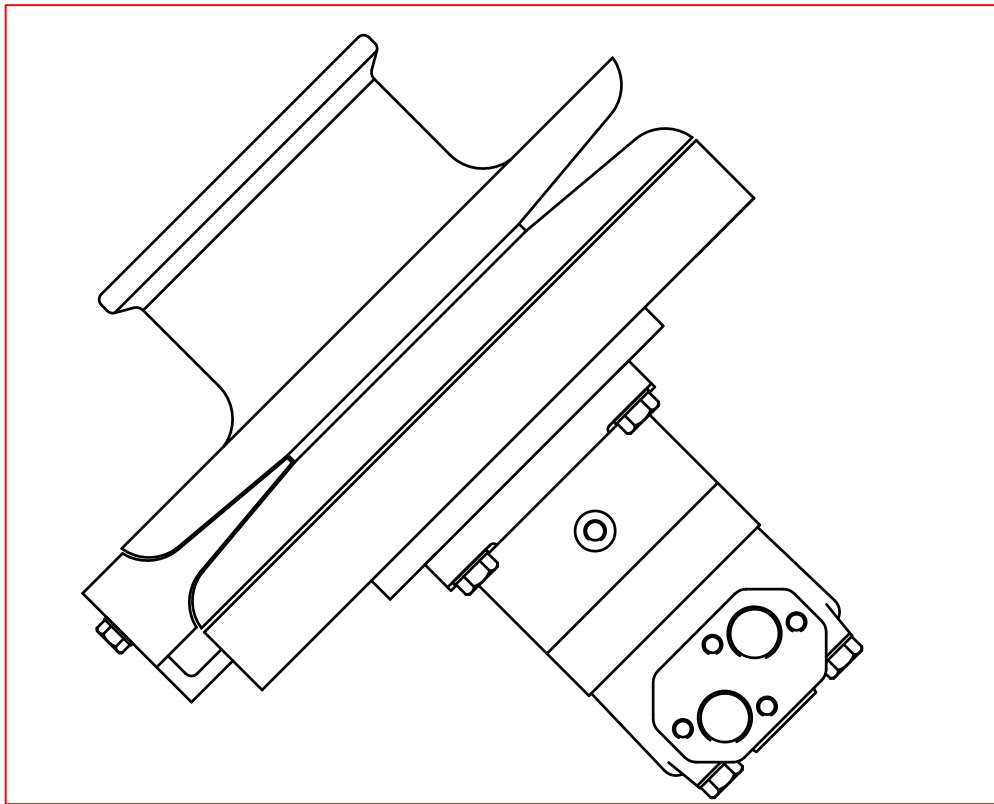

3000 LB SLAVE POT HAULER – SP3F

SUITABLE FOR POTTING USING 10 MM – 20 MM LINE SIZE

Wear Plates – Spun from Galvanised sheet steel

Line sheaves – Cast in S.G. iron grade 700/2

Warping drum – cast in S.G. iron grade 420/12

S.G. iron is a high grade, high strength material with superior resistance to wear and corrosion.

Ejector knife – Bronze, two sided and reversible.

Hydraulic motor – Low speed, High torque OMV series, by DANFOSS.

Bearings – Two sealed ball races are incorporated in the design assembly, to carry the full radial working load of the hauler.

Working loads are not imposed upon the hydraulic motor bearings.

Installation – Install into a console or bulkhead.

The line keep is an optional addition and is independantly fitted into the console or bulkhead face.

MOTOR SIZE 500 CC/REV
 MOTOR TORQUE 1460 NM @ 200 BAR

HYDRAULIC INPUT REQUIRED TO SUIT AVERAGE WORKING SPEED: –

INPUT FLOW 10 GL/MIN. (45 LITRES/MIN.)
 INPUT PRESSURE 3000 PSI. (200 BAR)

AVERAGE WORKING SPEED 165 FT/MIN. (50 METRES/MIN.)
 MAXIMUM WORKING SPEED 330 FT/MIN. (100 METRES/MIN.)
 MAXIMUM LINE PULL (ON Ø178) 3200 LB (1450 KG.)

TYPICAL CHOICE OF ASSOCIATED EQUIPMENT

HYDRAULIC PUMP/CLUTCH UNIT..... REF 3P14 (63 LITRES/MIN. @ 1000 RPM.)
 RESERVOIR REF R18 (80 LITRES CAPACITY)
 RETURN LINE FILTER REF F2
 CONTROL VALVE REF 2V3 (+ 2VC OPTIONAL)
 OIL COOLER (OPTIONAL)..... REF OC2
 HYDRAULIC HOSE 3/4" BORE 2 WIRE REINFORCED

WEIGHT OF HAULER HEAD 105 KG.

