

GILSEN BLOCKS with single or double sheaves, and with becket.
 Sheaves are replaceable hardened steel and are fitted with bronze
 bushed bearings.
 The spindle is drilled and fitted with a grease nipple for lubrication.
 Suitable for wire or rope.
 Fabricated steel frames are finished hot dip galvanised.

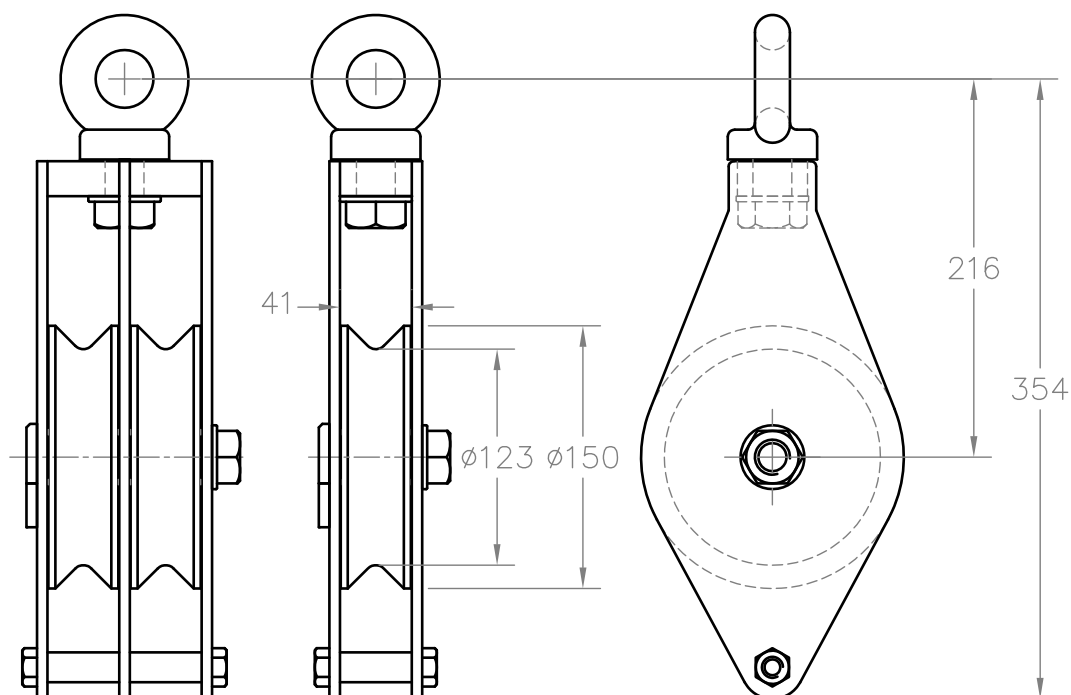

2 TON GILSEN BLOCK WITH BECKET
 SINGLE SHEAVE WT. 8.8 KG.
 DOUBLE SHEAVE WT. 14.2 KG.